

Forward in Faith Building for the Future



Accessibility Entrance Proposal

December 3rd 2017



LAURENTIAN
wesleyanCHURCH 
Following Christ. Growing Together.

"Therefore, since we have been justified through faith, we have peace with God through our Lord Jesus Christ, through whom we have gained access by faith into this grace in which we now stand. And we boast in the hope of the glory of God." Romans 5:1-2, NIV

Dear Church Family,

In 2017 Laurentian Wesleyan Church celebrates its 83rd anniversary! I'm so glad that Rev. Major felt called of God to step out in faith and begin the work here. I'm reminded of those faithful folks who stepped out in faith to build this building which has been such a blessing since it was completed in 1959. There have certainly been other moments in our history when steps of faith have been made, and more importantly than any building, we are thankful for those many men and women who have made the most important step of all...faith in Christ. And so to this day we come as we consider another step of faith which will impact future generations.

What does it mean to move "forward in faith"? We know that "without faith it is impossible to please God because anyone who comes to him must believe that he exists and that he rewards those who earnestly seek him." (Hebrews 11:6, NIV). We have been earnestly seeking God's direction over these past several months as to how our church can address the need for having an accessible entrance. As we think of those in our church family who have mobility challenges, I know we all desire to serve them in the best way we can. But it's bigger than that. The message of the Gospel is for everyone. Jesus said in Matthew 11:28; "Come to me, *all* you who are weary and burdened, and I will give you rest." Our church exists to invite people into a fully devoted, life-giving relationship with Jesus." Having an entrance that is open and welcoming to everyone is important, and let's face it, our front entrance is a barrier for some. I trust that we are on the same page with the *why*. It must be done.

If it must be done, the question turns to *what*? After much prayer, discussion, research and meetings you're holding in your hands what I believe is a great answer to that question. There are many options we've considered such as ramps, chair lifts, car ports, sling shots (just kidding), but all have come up short in one way or another. I remember when we started talking about building a new entrance; it resonated with us like nothing else. At the end of the day, we're not talking about a building, we're talking about people. This is a great plan which will help us serve people.

Let me state the obvious; this is a big project for our church. It's a significant investment. In a week, we are asking you to vote as to whether you are in agreement with this proposal in principle, and then the fund-raising will begin. We strive to be good stewards of the resources God has given us, but I come back to that phrase; "forward in faith". If we can calculate the future God has for us down to the last cent then really, this campaign should be called "forward in fact". But God rarely asks us to a task that we are over-qualified for. He wants to stretch us as we see Him do in and through us what only He can do. When we earnestly seek Him, and He leads us to the riverbank, there's a point where we need to step out and trust Him to make a way. I believe we're at that point. He will help us with the how.

Yes, there is more work to be done.

Yes, there will be sacrifice.

Yes, we will be asking you to give.

And yes, we believe that God will help us reach more people with His life giving message.

Join us as we go forward in faith and build for the future.

In Christ,

Pastor Jason

Aerial View of the Church Lot

- New addition will be on the north side of the church
- Existing front steps will be removed
- Side entrance next to the parsonage will remain

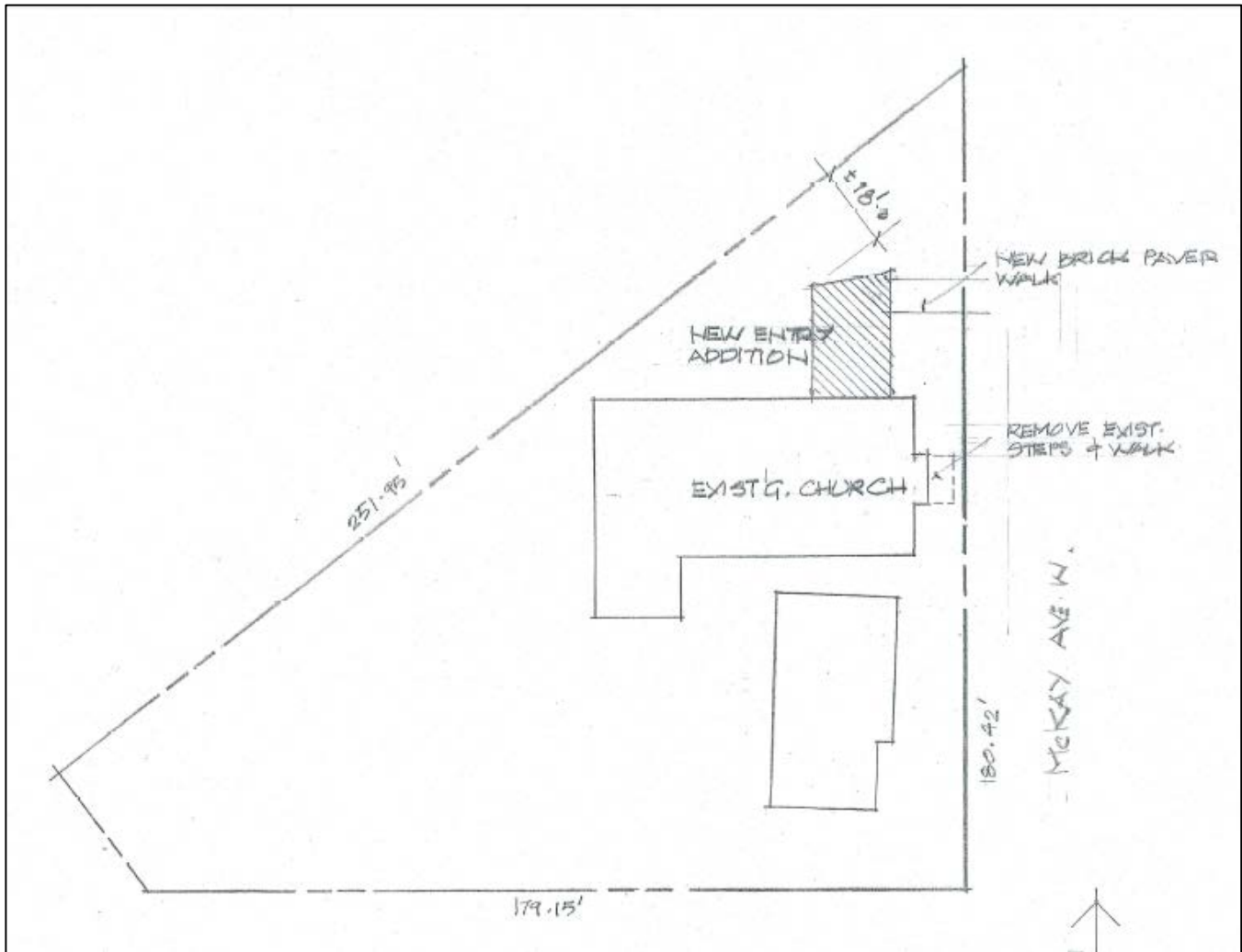

New Entrance and Foyer

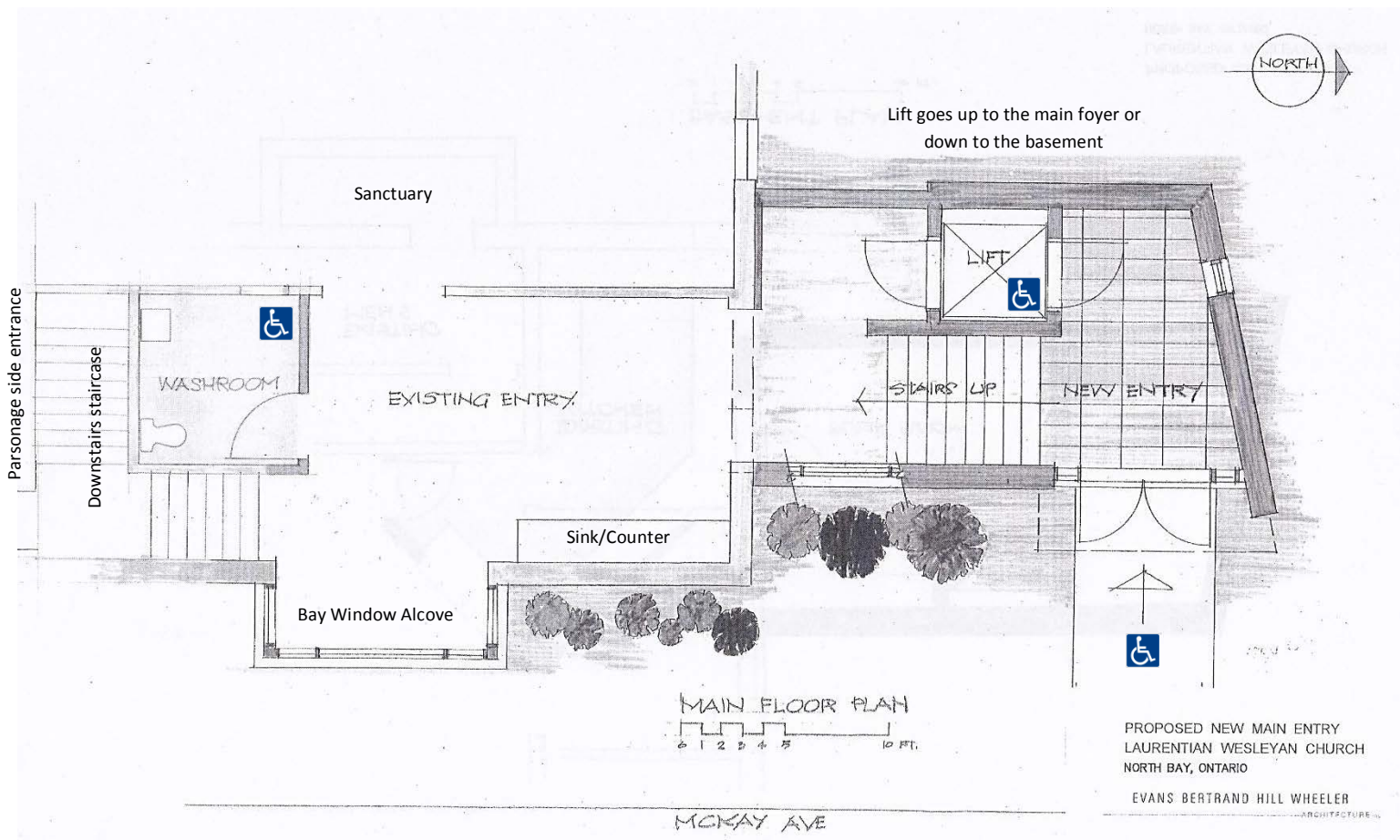

Changes to Existing Building

- Parsonage side entrance remains untouched
- An accessible washroom will be added upstairs in the refreshment area where the coat closet is currently located
- The front stairs will be removed completely
- The upper landing of the outside stairs will become an enclosed alcove with windows. This will provide much needed lighting and extra space in the refreshment area

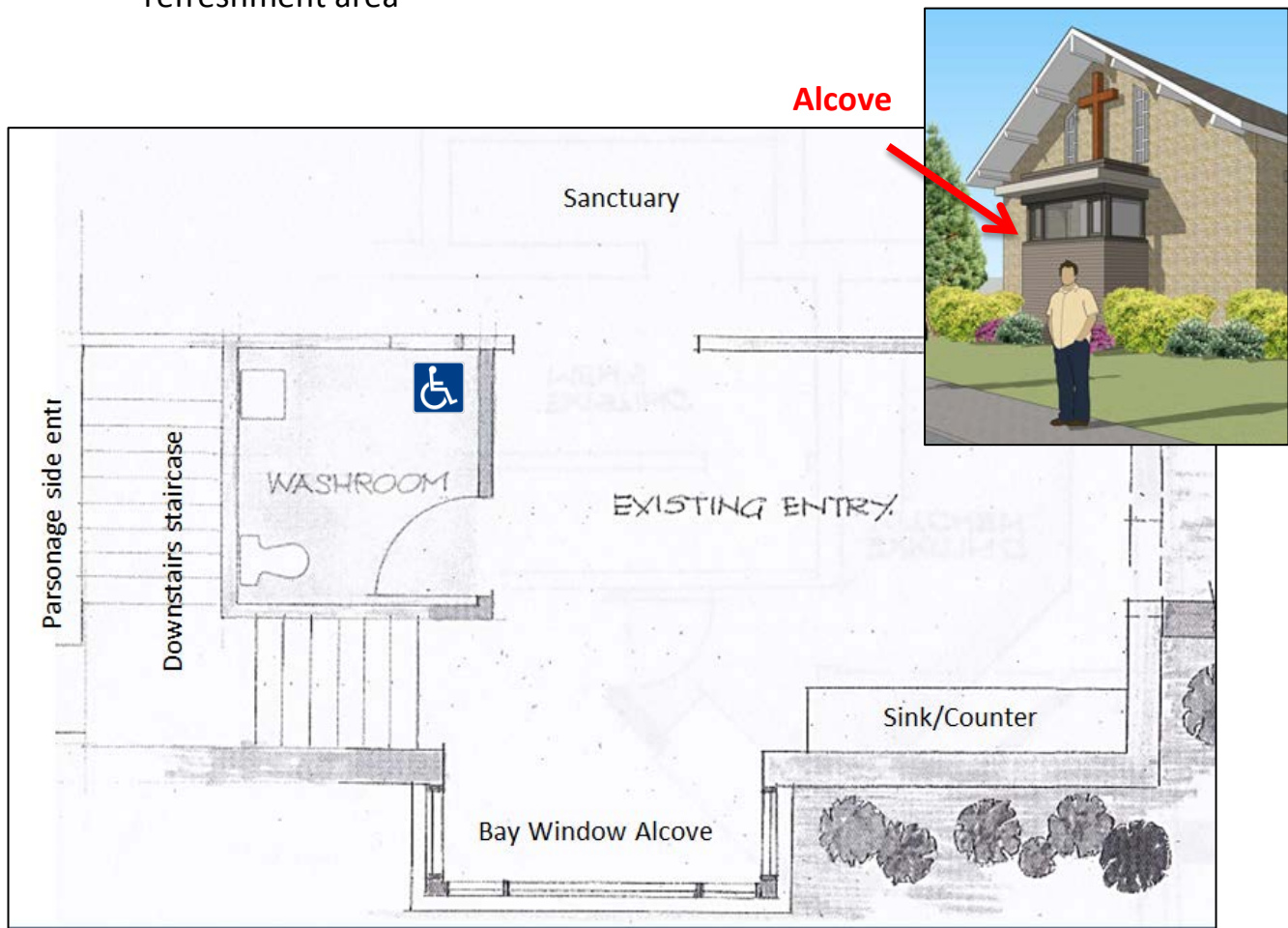

New Entrance and Addition

- This section, located on the north side of the church is entirely new
- Will have a ground floor entrance
- Will have a new staircase to enter the sanctuary
- A wheelchair lift goes either up to the sanctuary or down to the basement

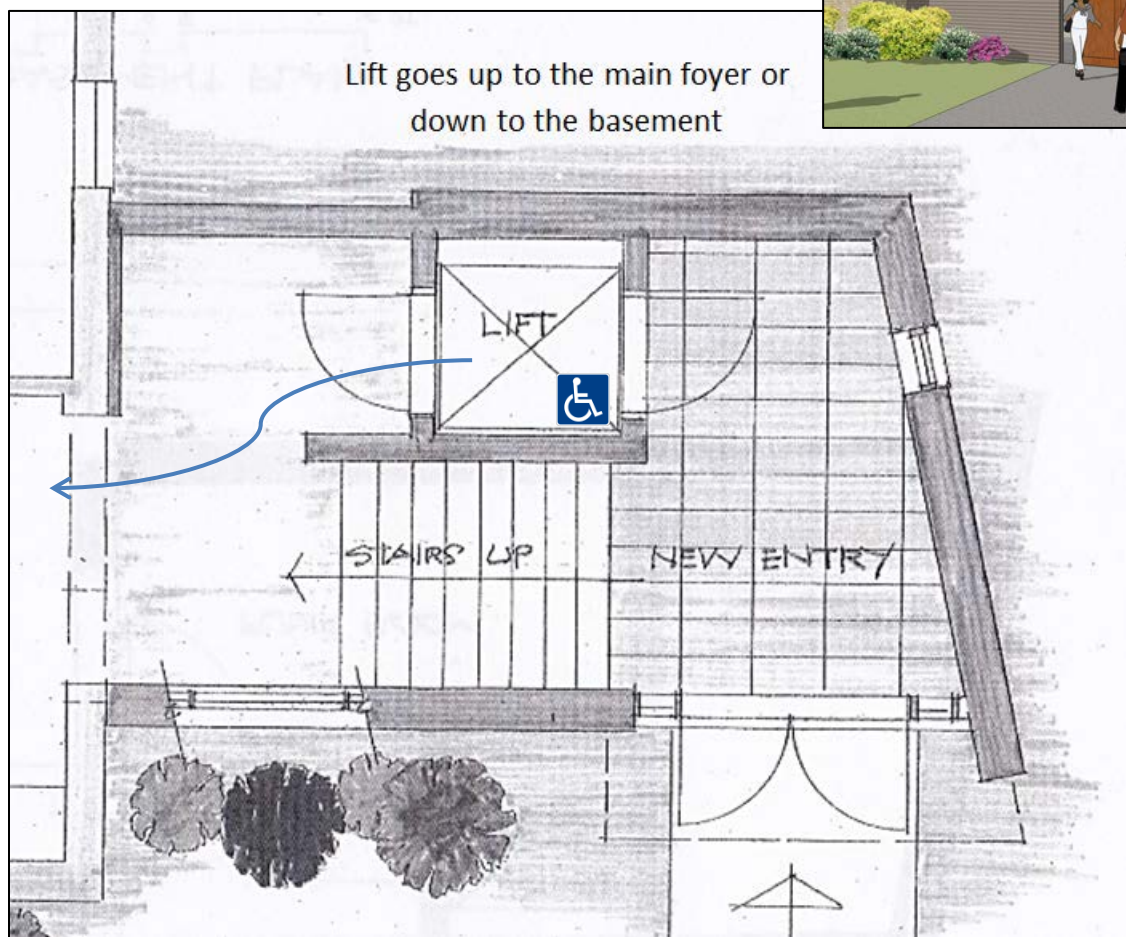

Changes to Basement to Accommodate the Lift

- The lift will descend and land in the newly built section of the church
- Guests will enter the basement into the room that is now currently located between the kitchen and the nursery
- The wall between the kitchen and room next to it will be modified to enlarge the existing kitchen

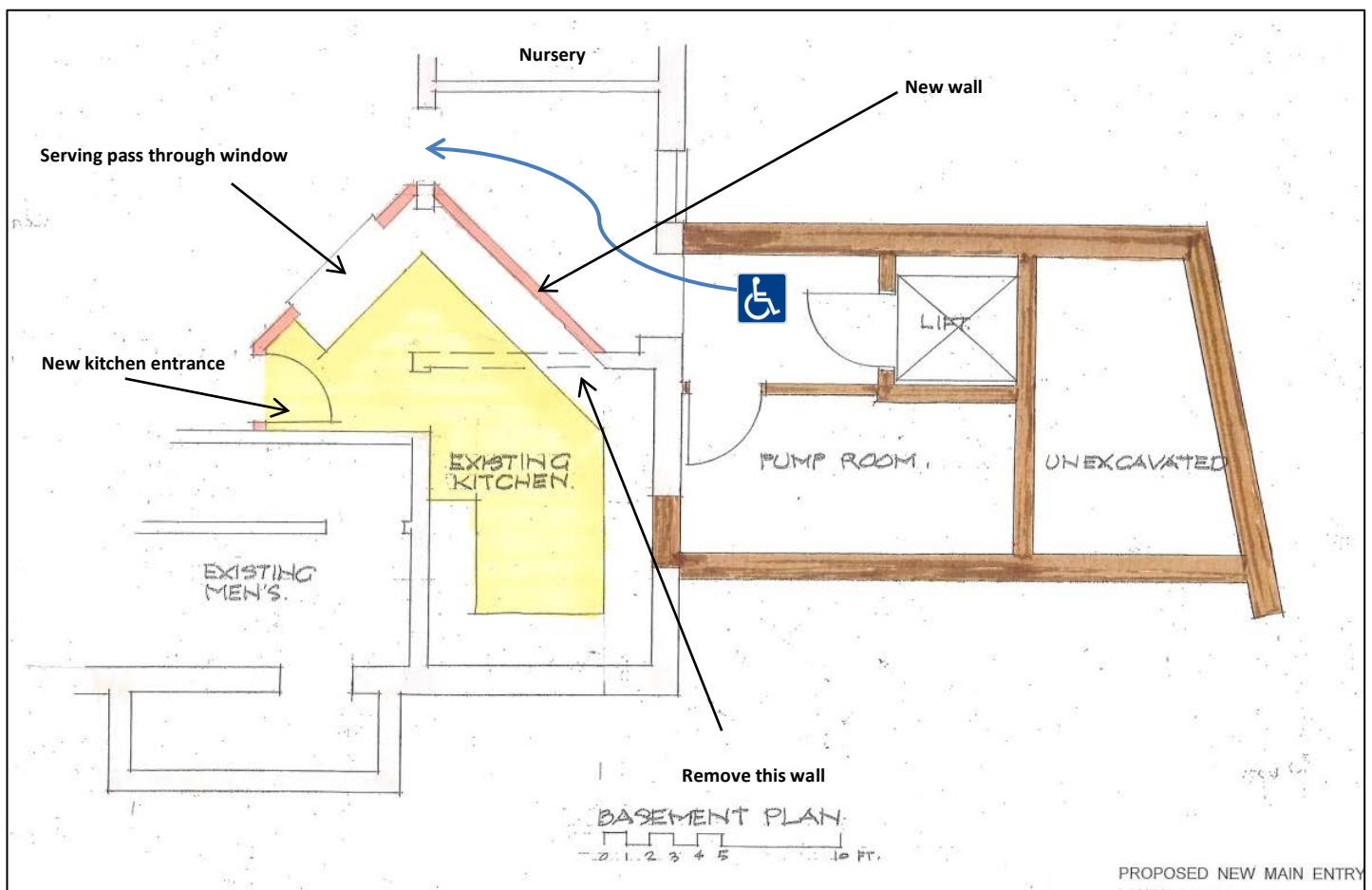

Cost

New Entrance	\$183,200.00
Old entry bay window	\$12,400.00
New washroom	\$11,700.00
Kitchen*	<u>\$17,500.00</u>
Subtotal	\$224,800.00
HST	<u>\$29,224.00</u>
Total	\$254,024.00

- Cost includes a 15% contractor overhead and profit.
- There is no contingency included.
- Cost does not consider 'sweat equity' (work we may do ourselves).
- Cost assumes electrical service is adequate for the lift and addition.

*Note that for the kitchen, there is no cost included for counters/cupboards, mechanical and electrical since we do not know what equipment/sinks will be required.



Financial Outlook

We will get to work fund-raising in our church with a goal of at least a third of the total cost of the project in hand before we break ground.

The remaining funds may come from:

- **Financing (loans)** Possibilities for financing include:
 - A loan from the Central Canada District of the Wesleyan Church.
 - A mortgage with the Wesleyan Investment Foundation or WIF (WIF is basically a bank who understands the unique issues with loaning to a church).
 - A mortgage from a local bank.
- **Further church fund-raising**
- **Government grants**

Other financial considerations:

We will also request that any money donated towards the building not be assessed for the United Stewardship Fund (USF) which is money we invest in the Wesleyan Church which goes towards a variety of ministries and services. We can also request that our USF payment be reduced while we fund-raise.

Timeline

The building committee is proposing breaking ground when we have met our goal of raising 1/3rd of the cost.

Next Steps

- Please feel free to ask questions today during our meeting (if you have questions during the week, please contact the church or the building committee).
- We are asking you to take some time this week and prayerfully consider your vote for this proposal.
- On **Sunday December 10th** we will have a vote. In the event that you are not able to attend the vote you may obtain an absentee ballot. Please speak to a member of the building committee or call the church.
- A vote "yes" means you are in support of this proposal in principle with the understanding we will not begin construction until at least 1/3 of the funds are raised and financing/or grants are secured.
- A vote "no" means you do not think we should pursue this project.
- Along with your personal vote, would you pray for the church as we consider this project together? We believe God has led us to this point and certainly want to follow His leading.

Thank you for your time, consideration and prayer,

Building Committee

(Tony Verlinden, Ed Vitunski, Pastor Jason McCutcheon and Chantal Szydlik)

Questions?